

AENC-TQST-LAN-DWG-0002

Norwich to Tilbury

Volume 2: Plans, Drawings and Sections

Document: 2.2 Land Plans - Section F

Final Issue A

August 2025

Planning Inspectorate Reference: EN020027

Infrastructure Planning (Applications: Prescribed Forms and Procedure)
Regulations 2009 Regulation 5(2)(i)(i)-(iii)

nationalgrid



LAND PLANS KEY PLAN

REGULATION 5(2)(i)(i)-(iii)

BRAINTREE DISTRICT COUNCIL, CHELMSFORD CITY COUNCIL AND BRENTWOOD BOROUGH COUNCIL)

SITE MAP

Legend

- Local authority boundary
- Section boundary & local authority boundary
- ... Section boundary
-  Sheet index
-  Order Limits

Notes

1. For additional detail on the plan suites, please refer to the Guide to Plans (document reference 2.0), located in the Volume 2 of the DCO application.
2. This drawing is scaled at paper size A0, therefore any prints taken at smaller sizes will affect accuracy of the measurement units and should not be scaled against.

Coordinate System: British National Grid

Sheet X Centroid Coordinate : 589989

Sheet Y Centroid Coordinate : 208832

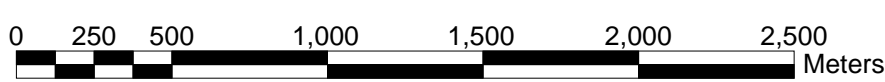

BACKGROUND MAPPING INFORMATION HAS BEEN REPRODUCED FROM THE ORDNANCE SURVEY BY PERMISSION OF ORDNANCE SURVEY OF THE CONTROLLER OF HIS MAJESTY'S STATIONERY OFFICE. © CROWN COPYRIGHT AND DATABASE RIGHTS(2025) LICENCE OS100024241 AND AC0000807948.

A	AUG-2025	For DCO Submission	CLJ	KPA	TPR
Issue	Date	Remarks	Drawn	Checked	Approved

Title:

THE NATIONAL GRID
(NORWICH TO TILBURY) ORDER
LAND PLANS KEY PLAN
REGULATION 5(2)(i)(i)-(iii)
SECTION F (SHEET 1 OF 1
BRAINTREE DISTRICT COUNCIL,
CHELMSFORD CITY COUNCIL,
D BRENTWOOD BOROUGH COUNCIL)

nationalgrid

PINS Application Number

EN020027

National Grid Drawing Reference

AENC-TQST-LAN-DWG-0002

<u>Scale</u>	<u>Sheet Size</u>	<u>Sheet</u>	<u>Issue</u>
1:18,000	A0	KEY PLAN	A

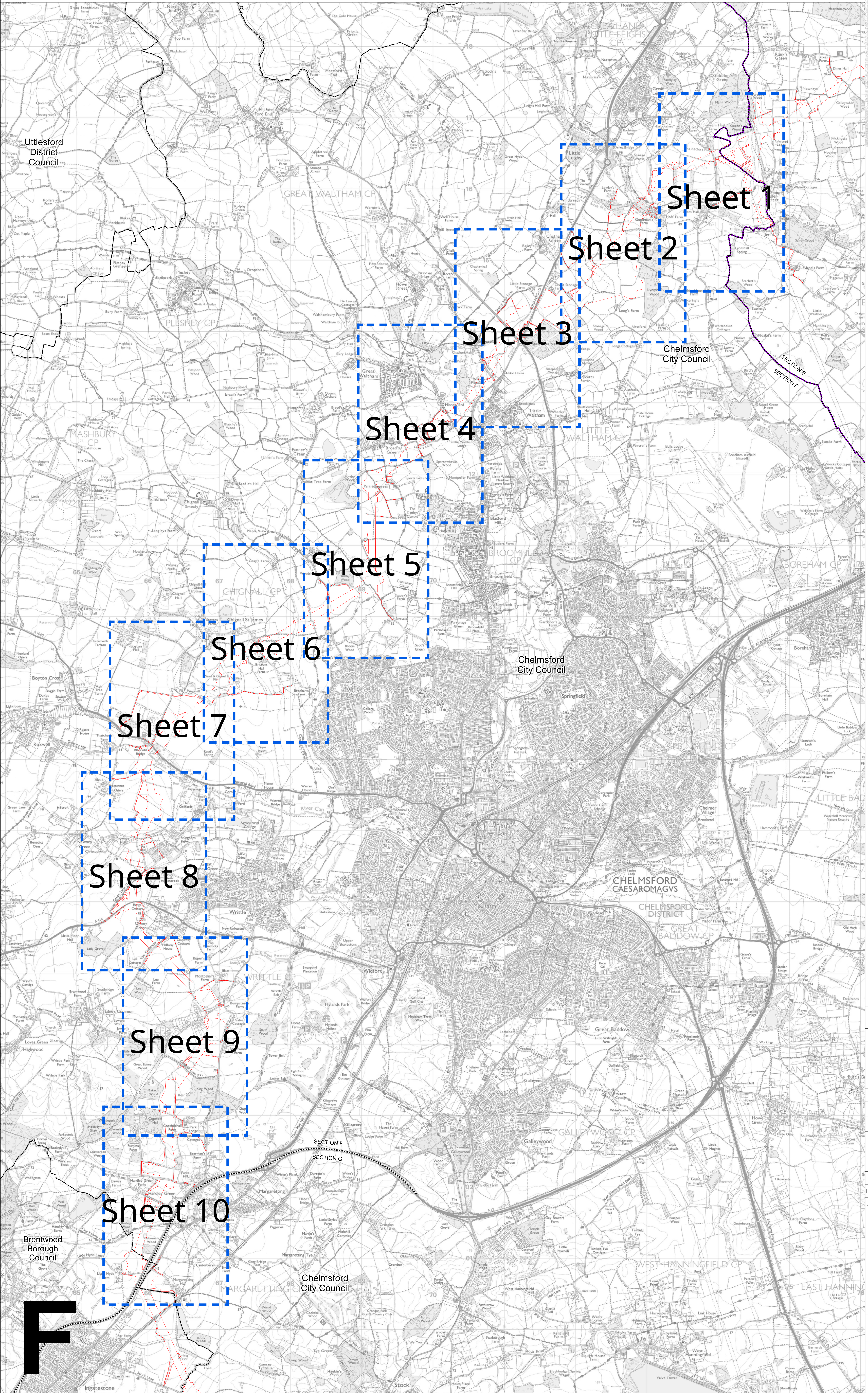

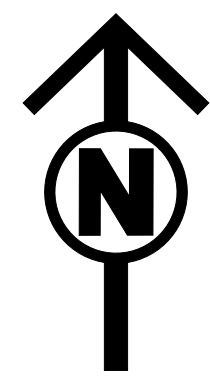

THE NATIONAL GRID (NORWICH TO TILBURY) ORDER
LAND PLANS
REGULATION 5(2)(i)-(iii)
SECTION F (SHEET 1 OF 10,
CHELMSFORD CITY COUNCIL AND BRAINTREE DISTRICT COUNCIL)

Application Document 2.2

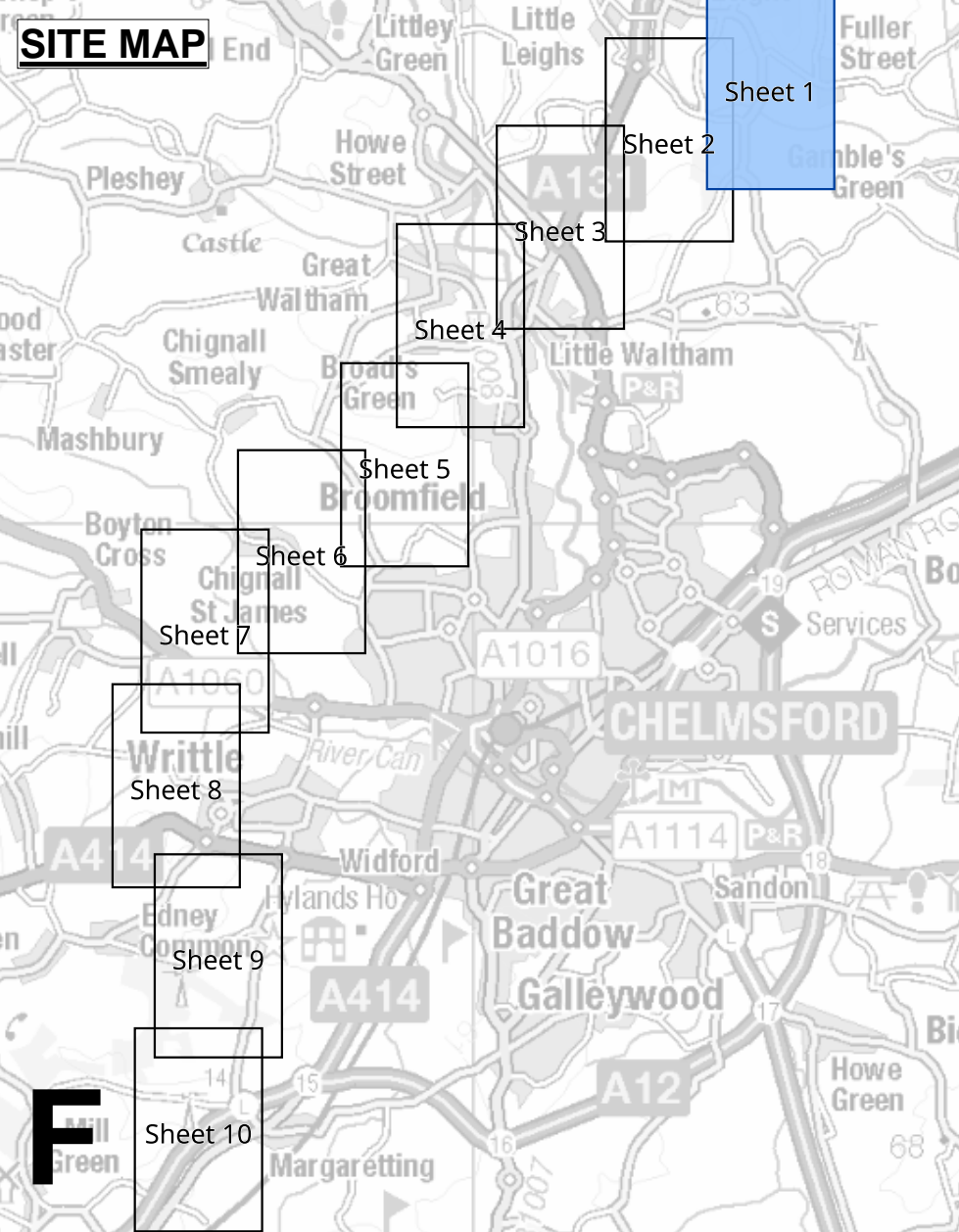

- Legend**
- Local authority boundary
 - Section boundary & local authority boundary
 - Section boundary
 - Sheet index outlines
 - Order Limits
 - Class 1 - Compulsory acquisition of land
 - Class 2 - Compulsory acquisition of rights - Overhead line
 - Class 3 - Compulsory acquisition of rights - Underground cable system
 - Class 4 - Compulsory acquisition of rights - Overhead line and underground cable system
 - Class 5 - Compulsory acquisition of rights - Access
 - Class 6 - Compulsory acquisition of rights - Drainage
 - Class 7 - Temporary use
 - Class 8 - Land not subject to powers of acquisition nor temporary use

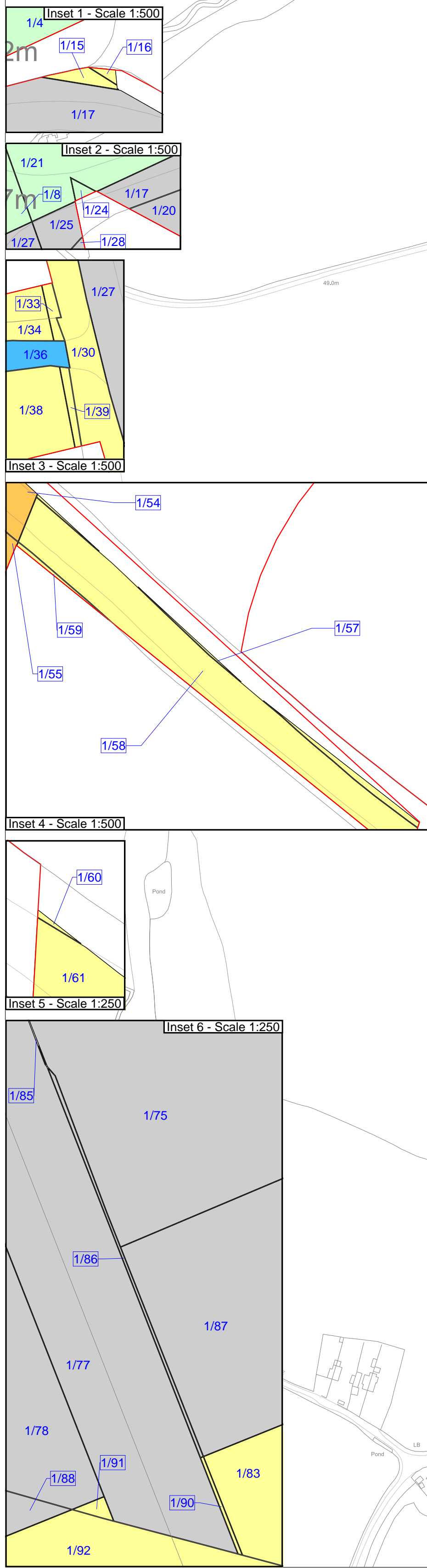
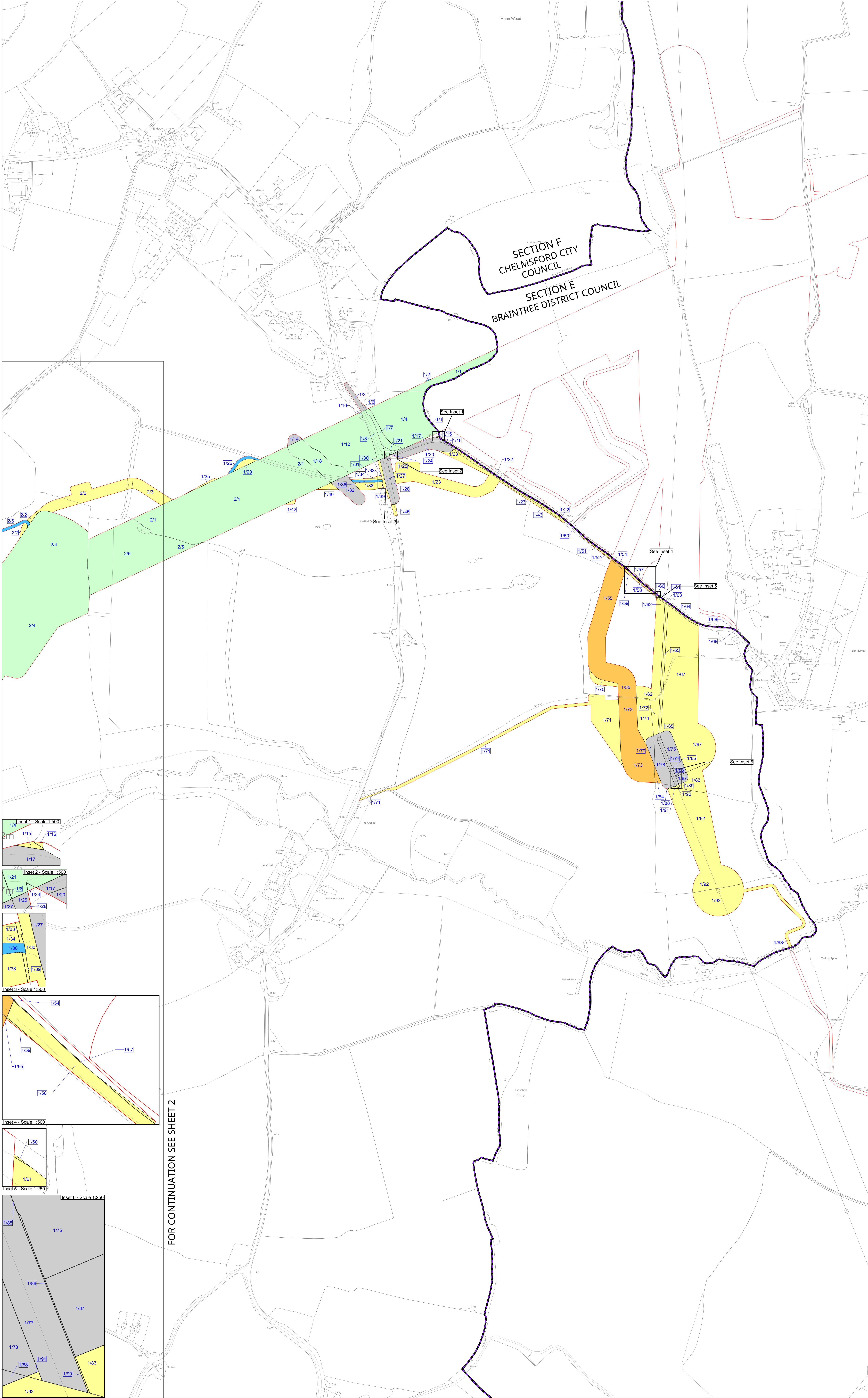

FOR CONTINUATION SEE SHEET 2

Notes
1. For additional detail on the plan suites, please refer to the Guide to Plans (document reference 2.0), located in the Volume 2 of the DCO application.
2. This drawing is scaled at paper size A0, therefore any prints taken at smaller sizes will affect accuracy of the measurement units and should not be scaled against.

Coordinate System: British National Grid
Sheet X Centroid Coordinate : 574051 Sheet Y Centroid Coordinate : 215956

BACKGROUND MAPPING INFORMATION HAS BEEN REPRODUCED FROM THE ORDNANCE SURVEY BY PERMISSION OF ORDNANCE SURVEY OF THE CONTROLLER OF HIS MAJESTY'S STATIONERY OFFICE. © CROWN COPYRIGHT AND DATABASE RIGHTS(2025) LICENCE OS100024241 AND AC0000807946.

Title:
THE NATIONAL GRID
(NORWICH TO TILBURY) ORDER
LAND PLANS
REGULATION 5(2)(i)-(iii)
SECTION F (SHEET 1 OF 10,
CHELMSFORD CITY COUNCIL AND
BRAINTREE DISTRICT COUNCIL)

PINS Application Number
EN020027

National Grid Drawing Reference
AENC-TQST-LAN-DWG-0002

Scale	Sheet Size	Sheet	Issue
1:2500	A0	SHEET 1 of 10	A

THE NATIONAL GRID (NORWICH TO TILBURY) ORDER
LAND PLANS
REGULATION 5(2)(i)-(iii)
SECTION F (SHEET 2 OF 10,
CHELMSFORD CITY COUNCIL)

Application Document 2.2

SITE MAP

Legend

- Local authority boundary
- Section boundary & local authority boundary
- Section boundary
- Sheet index outlines
- Order Limits
- Class 1 - Compulsory acquisition of land
- Class 2 - Compulsory acquisition of rights - Overhead line
- Class 3 - Compulsory acquisition of rights - Underground cable system
- Class 4 - Compulsory acquisition of rights - Overhead line and underground cable system
- Class 5 - Compulsory acquisition of rights - Access
- Class 6 - Compulsory acquisition of rights - Drainage
- Class 7 - Temporary use
- Class 8 - Land not subject to powers of acquisition nor temporary use

Notes

- For additional detail on the plan suites, please refer to the Guide to Plans (document reference 2.0), located in the Volume 2 of the DCO application.
- This drawing is scaled at paper size A0, therefore any prints taken at smaller sizes will affect accuracy of the measurement units and should not be scaled against.

Coordinate System: British National Grid

Sheet X Centroid Coordinate : 572670

Sheet Y Centroid Coordinate : 215243

0 50 100 150 200 250 Metres

BACKGROUND MAPPING INFORMATION HAS BEEN REPRODUCED FROM THE ORDNANCE SURVEY BY PERMISSION OF ORDNANCE SURVEY OF THE CONTROLLER OF HIS MAJESTY'S STATIONERY OFFICE. © CROWN COPYRIGHT AND DATABASE RIGHTS(2025) LICENCE OS100024241 AND AC0000807946.

Issue	Date	Remarks	Drawn	Checked	Approved
A	AUG-2025	For DCO submission	BBU	AMI	CLJ
Title:					
THE NATIONAL GRID (NORWICH TO TILBURY) ORDER LAND PLANS REGULATION 5(2)(i)-(iii) SECTION F (SHEET 2 OF 10 CHELMSFORD CITY COUNCIL)					

nationalgrid

PINS Application Number

EN020027

National Grid Drawing Reference

AENC-TQST-LAN-DWG-0002

Scale	Sheet Size	Sheet	Issue
1:2500	A0	SHEET 2 of 10	A

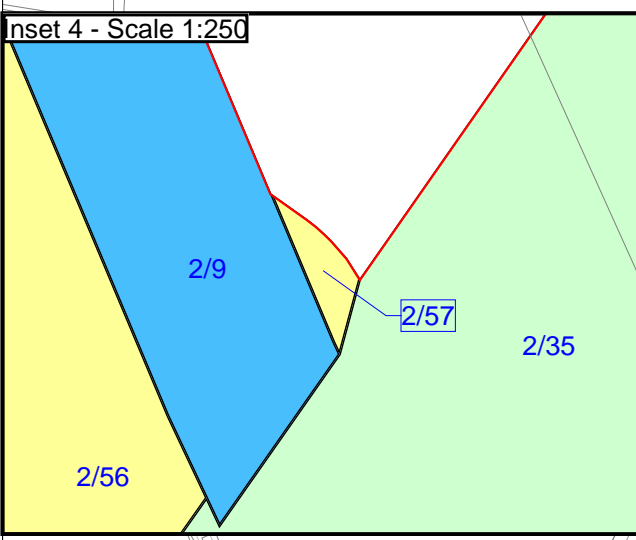
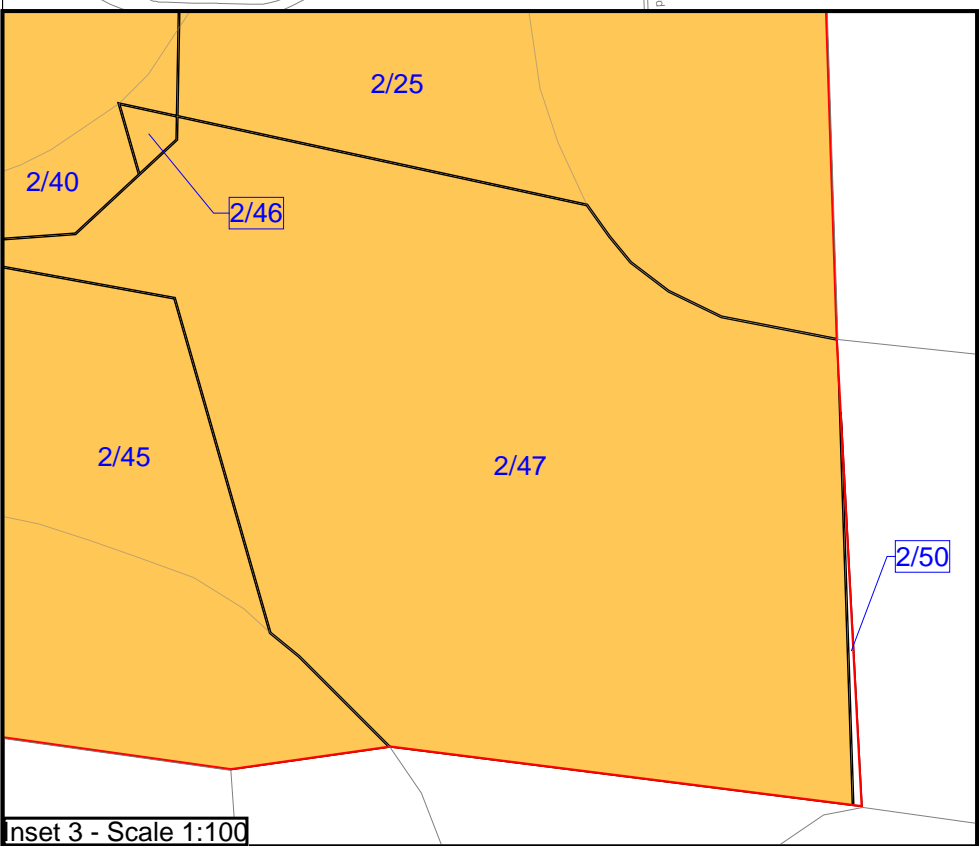
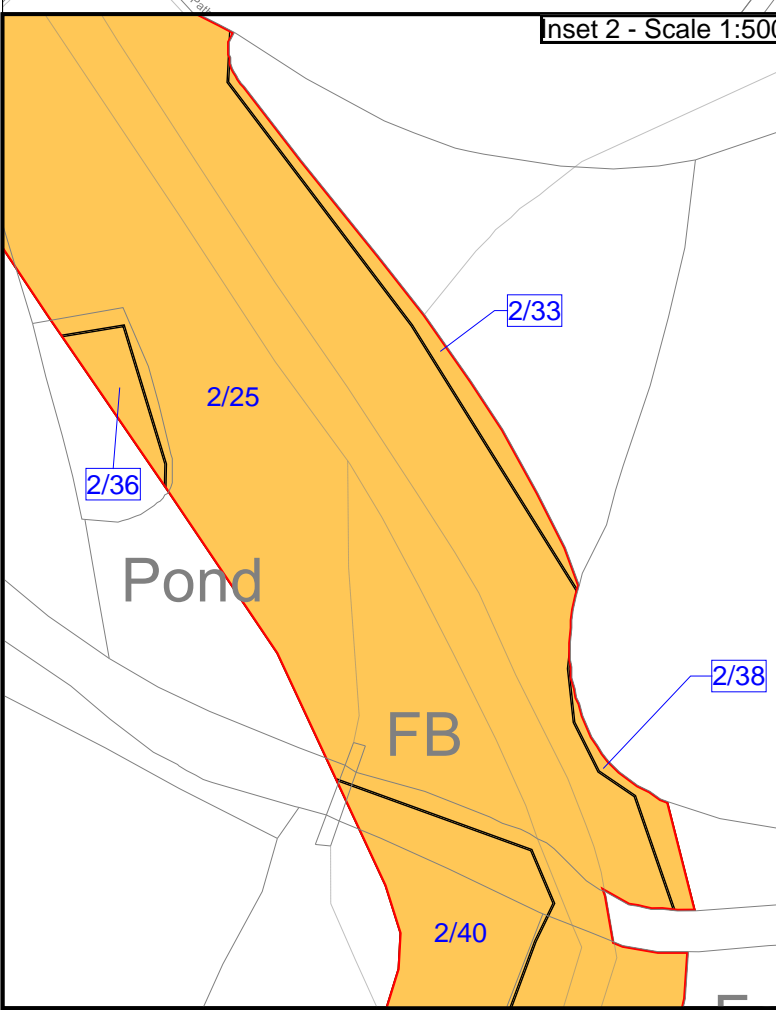
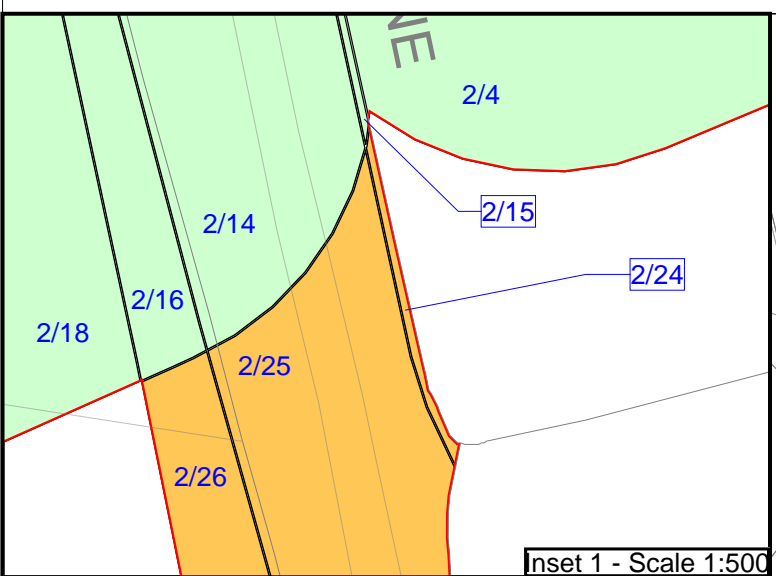
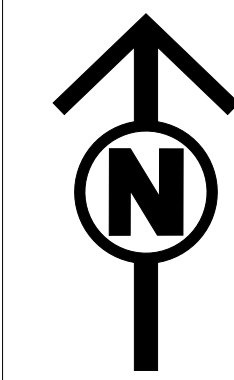

See Inset 1

See Inset 2

See Inset 3

See Inset 4

See Inset 5

See Inset 6

See Inset 7

See Inset 8

See Inset 9

See Inset 10

See Inset 11

See Inset 12

See Inset 13

See Inset 14

See Inset 15

See Inset 16

See Inset 17

See Inset 18

See Inset 19

See Inset 20

See Inset 21

See Inset 22

See Inset 23

See Inset 24

See Inset 25

See Inset 26

See Inset 27

See Inset 28

See Inset 29

See Inset 30

See Inset 31

See Inset 32

See Inset 33

See Inset 34

See Inset 35

See Inset 36

See Inset 37

See Inset 38

See Inset 39

See Inset 40

See Inset 41

See Inset 42

See Inset 43

See Inset 44

See Inset 45

See Inset 46

See Inset 47

See Inset 48

See Inset 49

See Inset 50

See Inset 51

See Inset 52

See Inset 53

See Inset 54

See Inset 55

See Inset 56

See Inset 57

See Inset 58

See Inset 59

See Inset 60

See Inset 61

See Inset 62

See Inset 63

See Inset 64

See Inset 65

See Inset 66

See Inset 67

See Inset 68

See Inset 69

See Inset 70

See Inset 71

See Inset 72

See Inset 73

See Inset 74

See Inset 75

See Inset 76

See Inset 77

See Inset 78

See Inset 79

See Inset 80

See Inset 81

See Inset 82

See Inset 83

See Inset 84

See Inset 85

See Inset 86

See Inset 87

See Inset 88

See Inset 89

See Inset 90

See Inset 91

See Inset 92

See Inset 93

See Inset 94

See Inset 95

See Inset 96

See Inset 97

See Inset 98

See Inset 99

See Inset 100

See Inset 101

See Inset 102

See Inset 103

See Inset 104

See Inset 105

See Inset 106

See Inset 107

See Inset 108

See Inset 109

See Inset 110

See Inset 111

See Inset 112

See Inset 113

See Inset 114

See Inset 115

See Inset 116

See Inset 117

See Inset 118

See Inset 119

See Inset 120

See Inset 121

See Inset 122

See Inset 123

See Inset 124

See Inset 125

See Inset 126

See Inset 127

See Inset 128

See Inset 129

See Inset 130

See Inset 131

See Inset 132

See Inset 133

See Inset 134

See Inset 135

See Inset 136

See Inset 137

See Inset 138

See Inset 139

See Inset 140

See Inset 141

See Inset 142

See Inset 143

See Inset 144

See Inset 145

See Inset 146

See Inset 147

See Inset 148

See Inset 149

See Inset 150

See Inset 151

See Inset 152

See Inset 153

See Inset 154

See Inset 155

See Inset 156

See Inset 157

See Inset 158

See Inset 159

See Inset 160

See Inset 161

See Inset 162

See Inset 163

See Inset 164

See Inset 165

See Inset 166

See Inset 167

See Inset 168

See Inset 169

See Inset 170

See Inset 171

See Inset 172

See Inset 173

See Inset 174

See Inset 175

See Inset 176

See Inset 177

See Inset 178

See Inset 179

See Inset 180

See Inset 181

See Inset 182

See Inset 183

See Inset 184

See Inset 185

See Inset 186

See Inset 187

See Inset 188

See Inset 189

See Inset 190

See Inset 191

See Inset 192

See Inset 193

See Inset 194

See Inset 195

See Inset 196

See Inset 197

See Inset 198

See Inset 199

See Inset 200

See Inset 201

See Inset 202

See Inset 203

See Inset 204

See Inset 205

See Inset 206

See Inset 207

See Inset 208

See Inset 209

See Inset 210

See Inset 211

See Inset 212

See Inset 213

See Inset 214

See Inset 215

See Inset 216

See Inset 217

See Inset 218

See Inset 219

See Inset 220

See Inset 221

See Inset 222

See Inset 223

See Inset 224

See Inset 225

See Inset 226

See Inset 227

See Inset 228

See Inset 229

See Inset 230

See Inset 231

See Inset 232

See Inset 233

See Inset 234

See Inset 235

See Inset 236

See Inset 237

See Inset 238

See Inset 239

See Inset 240

See Inset 241

See Inset 242

See Inset 243

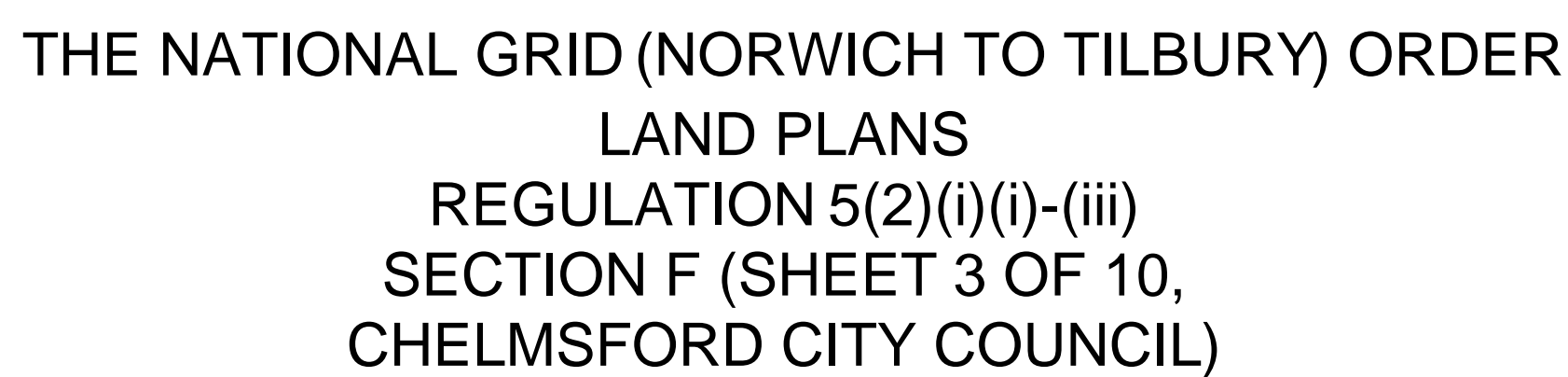

- - - Local authority boundary
- Section boundary & local authority boundary
- Section boundary
- Sheet index cutlines
- Order Limits
- Class 1 - Compulsory acquisition of land
- Class 2 - Compulsory acquisition of rights - Overhead line
- Class 3 - Compulsory acquisition of rights - Underground cable system
- Class 4 - Compulsory acquisition of rights - Overhead line and underground cable system
- Class 5 - Compulsory acquisition of rights - Access
- Class 6 - Compulsory acquisition of rights - Drainage
- Class 7 - Temporary use
- Class 8 - Land not subject to powers of acquisition nor temporary use

Notes

1. For additional detail on the plan suites, please refer to the Guide to Plans (document reference 2.0), located in the Volume 2 of the DCO application.

2. This drawing is scaled at paper size A0, therefore any prints taken at smaller sizes will affect accuracy of the measurement units and should not be scaled against.

Coordinate System: British National Grid

Sheet X Centroid Coordinate : 571184

Sheet Y Centroid Coordinate : 214051

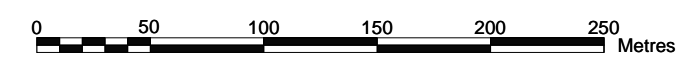

BACKGROUND MAPPING INFORMATION HAS BEEN REPRODUCED FROM THE ORDNANCE SURVEY BY PERMISSION OF ORDNANCE SURVEY OF THE CONTROLLER OF HIS MAJESTY'S STATIONERY OFFICE. © CROWN COPYRIGHT AND DATABASE RIGHTS(2025) LICENCE OS100024241 AND AC0000807948.

A	AUG-2025	For DCO submission	BBU	KGA	CLJ
Issue	Date	Remarks	Drawn	Checked	Approved

Title:

THE NATIONAL GRID
(NORWICH TO TILBURY) ORDER
LAND PLANS
REGULATION 5(2)(i)-(iii)
SECTION F (SHEET 3 OF 10
CHELMSFORD CITY COUNCIL)

nationalgrid

PINS Application Number

EN020027

National Grid Drawing Reference

AFNC-TOST-I AN-DWG-0002

<u>Scale</u>	<u>Sheet Size</u>	<u>Sheet</u>	<u>Issue</u>
1:2500	A0	SHEET 3 of 10	A

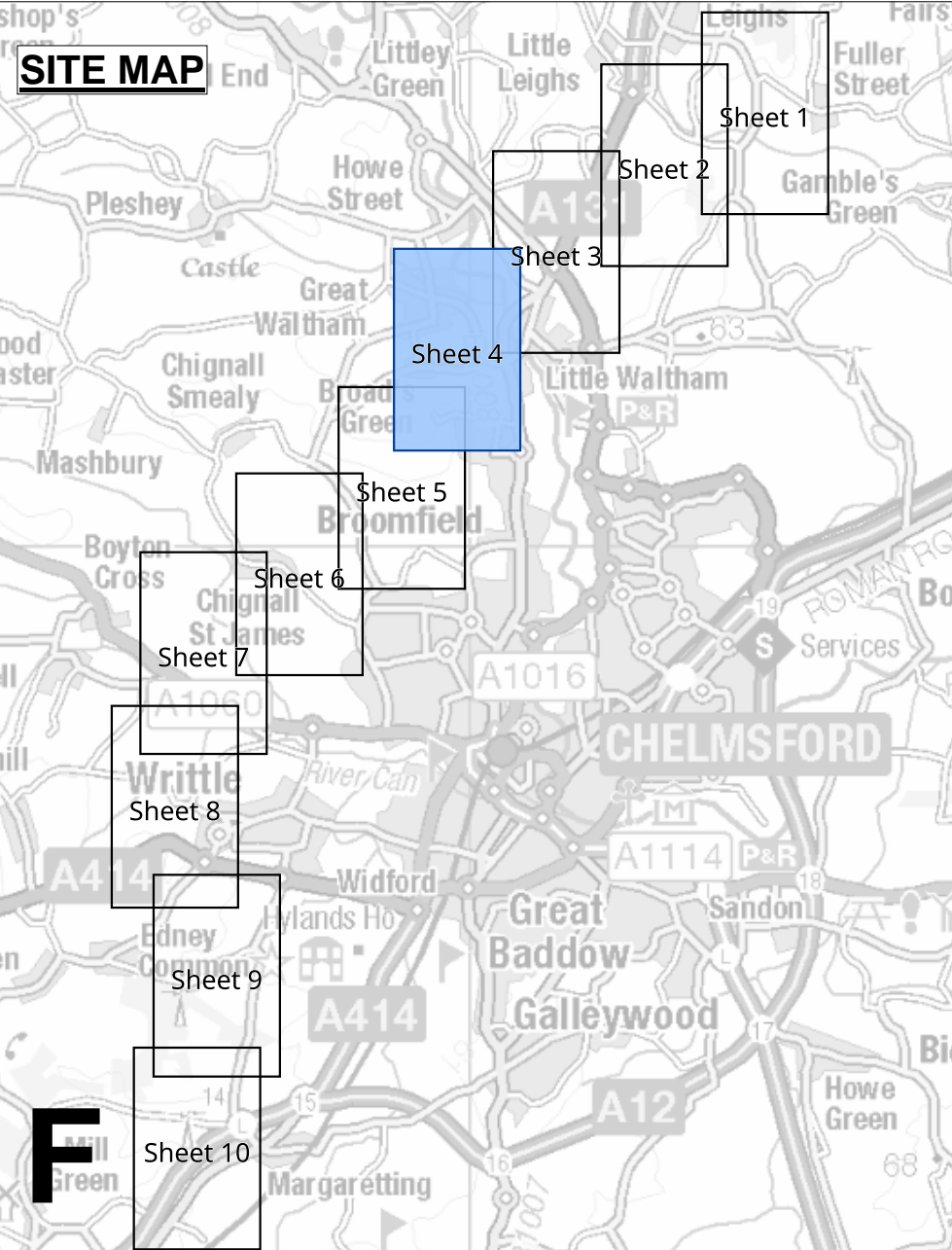
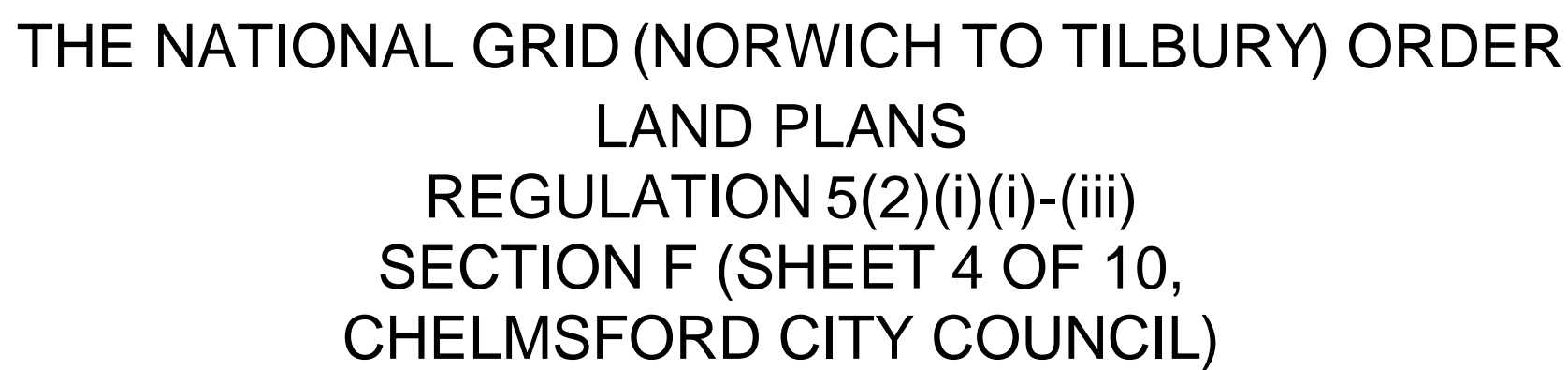

Legend

- Local authority boundary
- Section boundary & local authority boundary
- Section boundary
- Sheet index outlines
- Order Limits
- Class 1 - Compulsory acquisition of land
- Class 2 - Compulsory acquisition of rights - Overhead line
- Class 3 - Compulsory acquisition of rights - Underground cable system
- Class 4 - Compulsory acquisition of rights - Overhead line and underground cable system
- Class 5 - Compulsory acquisition of rights - Access
- Class 6 - Compulsory acquisition of rights - Drainage
- Class 7 - Temporary use
- Class 8 - Land not subject to powers of acquisition nor temporary use

Notes

2. This drawing is scaled at paper size A0, therefore any prints taken at smaller sizes will affect accuracy of the measurement units and should not be scaled against.

Coordinate System: British National Grid

Sheet X Centroid Coordinate : 56982'

Sheet Y Centroid Coordinate : 212709



BACKGROUND MAPPING INFORMATION HAS BEEN REPRODUCED FROM THE ORDNANCE SURVEY BY PERMISSION OF ORDNANCE SURVEY OF THE CONTROLLER OF HIS MAJESTY'S STATIONERY OFFICE. © CROWN COPYRIGHT AND DATABASE RIGHTS(2025) LICENCE OS100024241 AND AC0000807948.

A	AUG-2025	For DCO submission	SGR	KGA	CLJ

Title

THE NATIONAL GRID
(NORWICH TO TILBURY) ORDER
LAND PLANS
REGULATION 5(2)(i)(i)-(iii)
SECTION F (SHEET 4 OF 10
CHELMSFORD CITY COUNCIL)

nationalgrid

PINS Application Number

EN020027

National Grid Drawing Reference

AFNC-TOST-I LAN-DWG-0002

<u>Scale</u>	<u>Sheet Size</u>	<u>Sheet</u>	<u>Issue</u>
1:2500	A0	SHEET 4 of 10	A

FOR CONTINUATION SEE SHEET 5

FOR CONTINUATION SEE SHEET 3

COPYRIGHT: NOT TO BE REPRODUCED WITHOUT THE WRITTEN PERMISSION OF NATIONAL GRID ELECTRICITY TRANSMISSION Plc

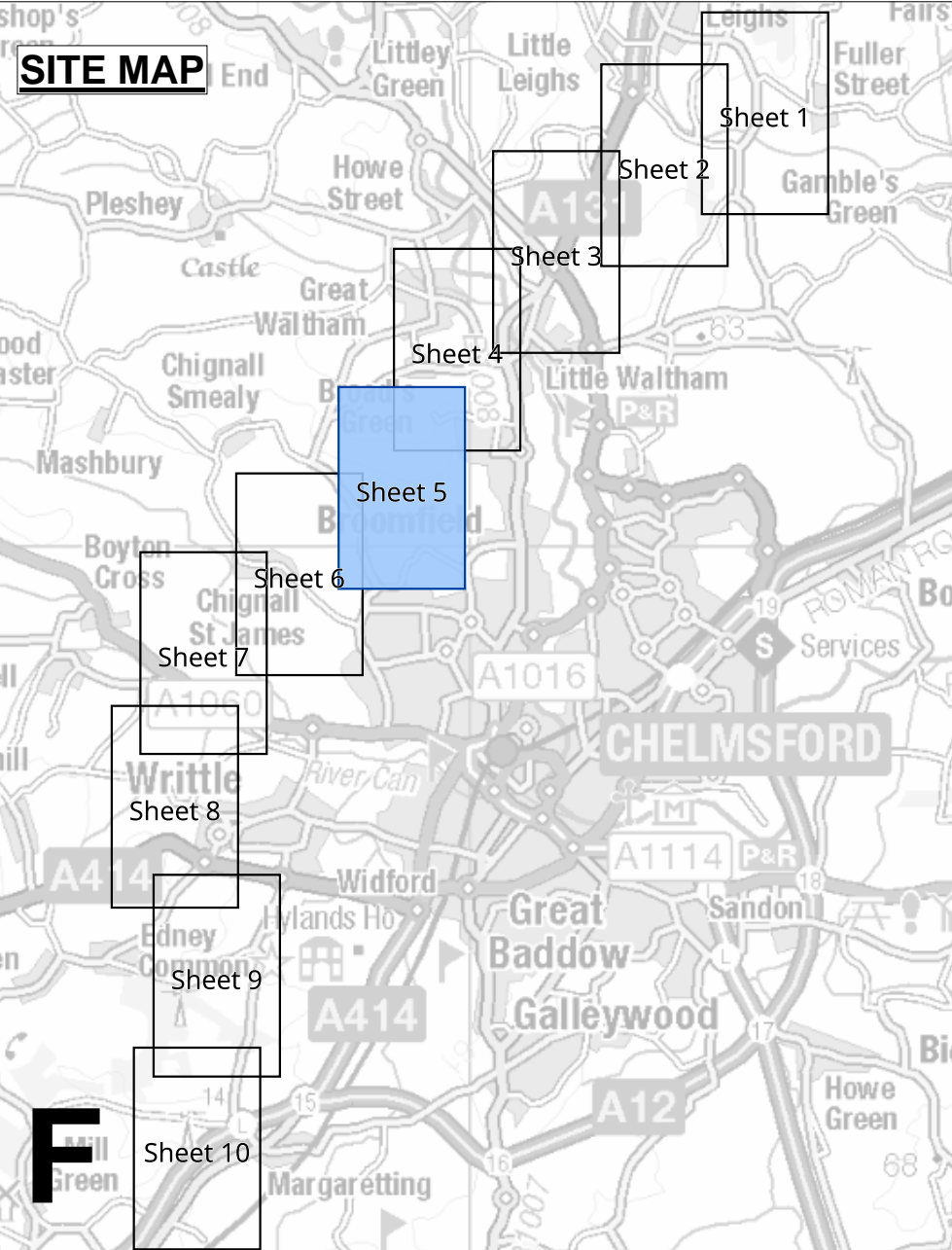
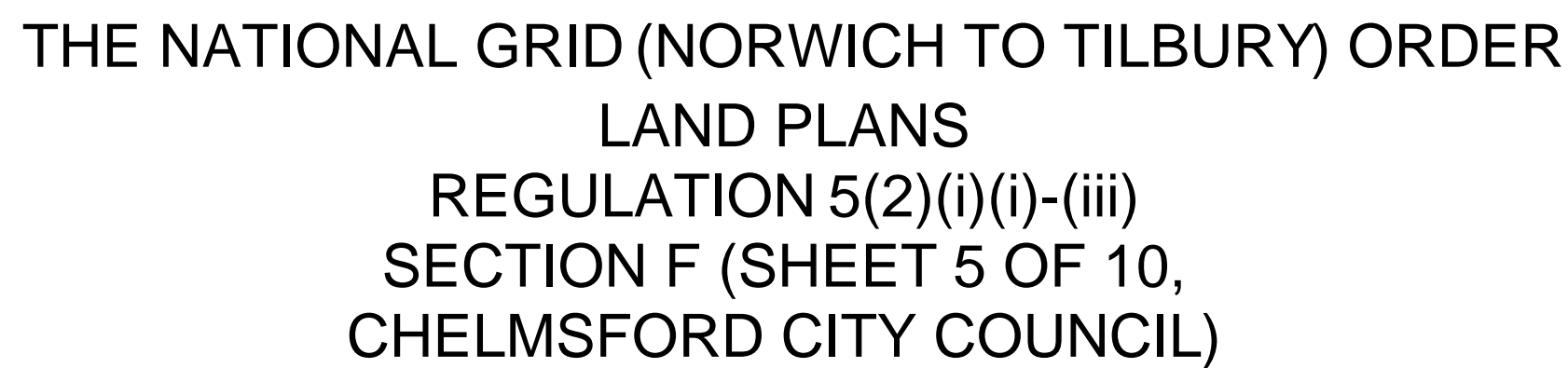

- Local authority boundary
- Section boundary & local authority boundary
- Section boundary
- Sheet index outlines
- Order Limits
- Class 1 - Compulsory acquisition of land
- Class 2 - Compulsory acquisition of rights - Overhead line
- Class 3 - Compulsory acquisition of rights - Underground cable system
- Class 4 - Compulsory acquisition of rights - Overhead line and underground cable system
- Class 5 - Compulsory acquisition of rights - Access
- Class 6 - Compulsory acquisition of rights - Drainage
- Class 7 - Temporary use
- Class 8 - Land not subject to powers of acquisition nor temporary use

FOR CONTINUATION SEE SHEET 4

FOR CONTINUATION SEE SHEET 6

2. This drawing is scaled at paper size A0, therefore any prints taken at smaller sizes will affect accuracy of the measurement units and should not be scaled against.

Coordinate System: British National Grid
Sheet X Centroid Coordinate : 569061 Sheet Y Centroid Coordinate : 210810

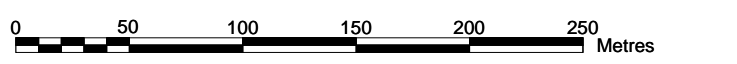

BACKGROUND MAPPING INFORMATION HAS BEEN REPRODUCED FROM THE ORDNANCE SURVEY BY PERMISSION OF ORDNANCE SURVEY OF THE CONTROLLER OF HIS MAJESTY'S STATIONERY OFFICE. © CROWN COPYRIGHT AND DATABASE RIGHTS(2025) LICENCE OS100024241 AND AC0000807948.

A	AUG-2025	For DCO submission	KGA	CBE	CLJ
Issue	Date	Remarks	Drawn	Checked	Approved
Title:					

Title

THE NATIONAL GRID
(NORWICH TO TILBURY) ORDER
LAND PLANS
REGULATION 5(2)(i)(i)-(iii)
SECTION F (SHEET 5 OF 10
CHELMSFORD CITY COUNCIL)

nationalgrid

PINS Application Number

EN020027

National Grid Drawing Reference

AENC-TQST-LAN-DWG-0002

<u>Scale</u>	<u>Sheet Size</u>	<u>Sheet</u>	<u>Issue</u>
1:2500	A0	SHEET 5 of 10	A

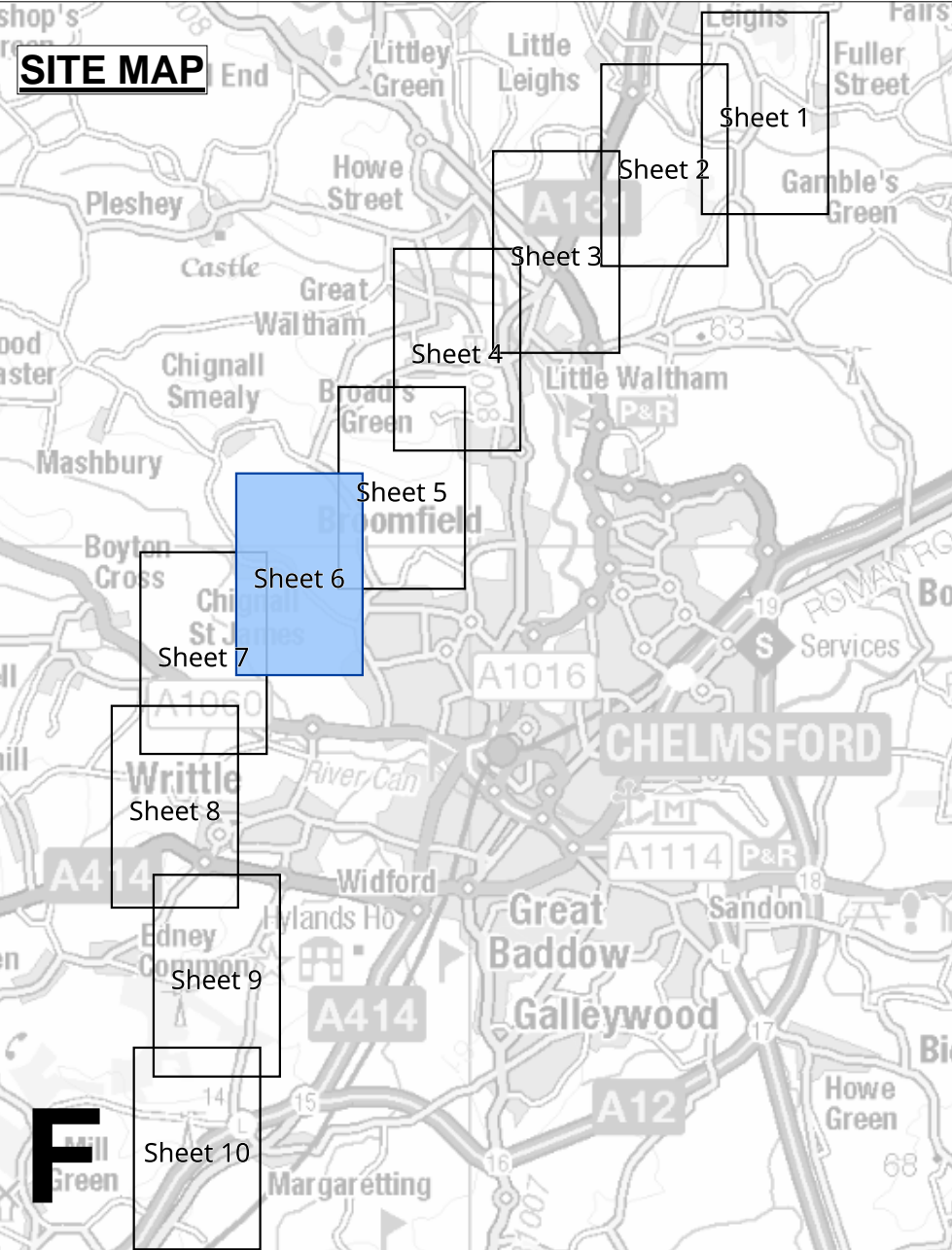
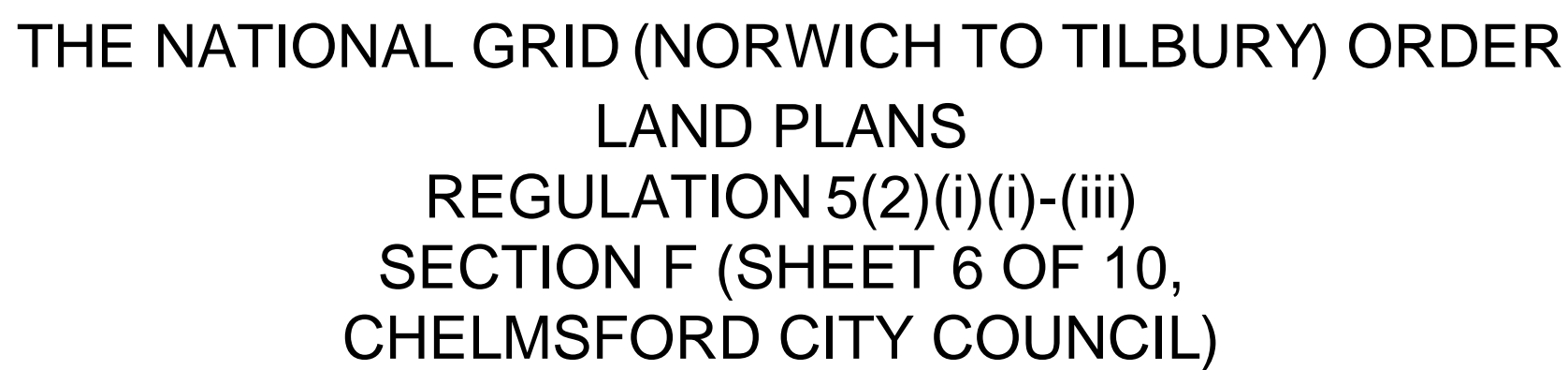

Legend

- Local authority boundary
- Section boundary & local authority boundary
- Section boundary
- Sheet index outlines
- Order Limits
- Class 1 - Compulsory acquisition of land
- Class 2 - Compulsory acquisition of rights - Overhead line
- Class 3 - Compulsory acquisition of rights - Underground cable system
- Class 4 - Compulsory acquisition of rights - Overhead line and underground cable system
- Class 5 - Compulsory acquisition of rights - Access
- Class 6 - Compulsory acquisition of rights - Drainage
- Class 7 - Temporary use
- Class 8 - Land not subject to powers of acquisition nor temporary use

Notes

2. This drawing is scaled at paper size A0, therefore any prints taken at smaller sizes will affect accuracy of the measurement units and should not be scaled against.

Coordinate System: British National Grid

Sheet X Centroid Coordinate : 567654 Sheet Y Centroid Coordinate : 209624

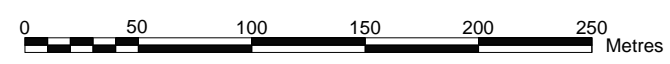

BACKGROUND MAPPING INFORMATION HAS BEEN REPRODUCED FROM THE ORDNANCE SURVEY BY PERMISSION OF ORDNANCE SURVEY OF THE CONTROLLER OF HIS MAJESTY'S STATIONERY OFFICE. © CROWN COPYRIGHT AND DATABASE RIGHTS(2025) LICENCE OS100024241 AND AC0000807948.

A	AUG-2025	For DCO submission	SGR	BBU	CLJ
Issue	Date	Remarks	Drawn	Checked	Approved

THE NATIONAL GRID
(NORWICH TO TILBURY) ORDER
LAND PLANS
REGULATION 5(2)(i)-(iii)
SECTION F (SHEET 6 OF 10
CHELMSFORD CITY COUNCIL)

nationalgrid

PINS Application Number

EN020027

National Grid Drawing Reference

AENC-TQST-LAN-DWG-0002

<u>Scale</u>	<u>Sheet Size</u>	<u>Sheet</u>	<u>Issue</u>
1:2500	A0	SHEET 6 of 10	A

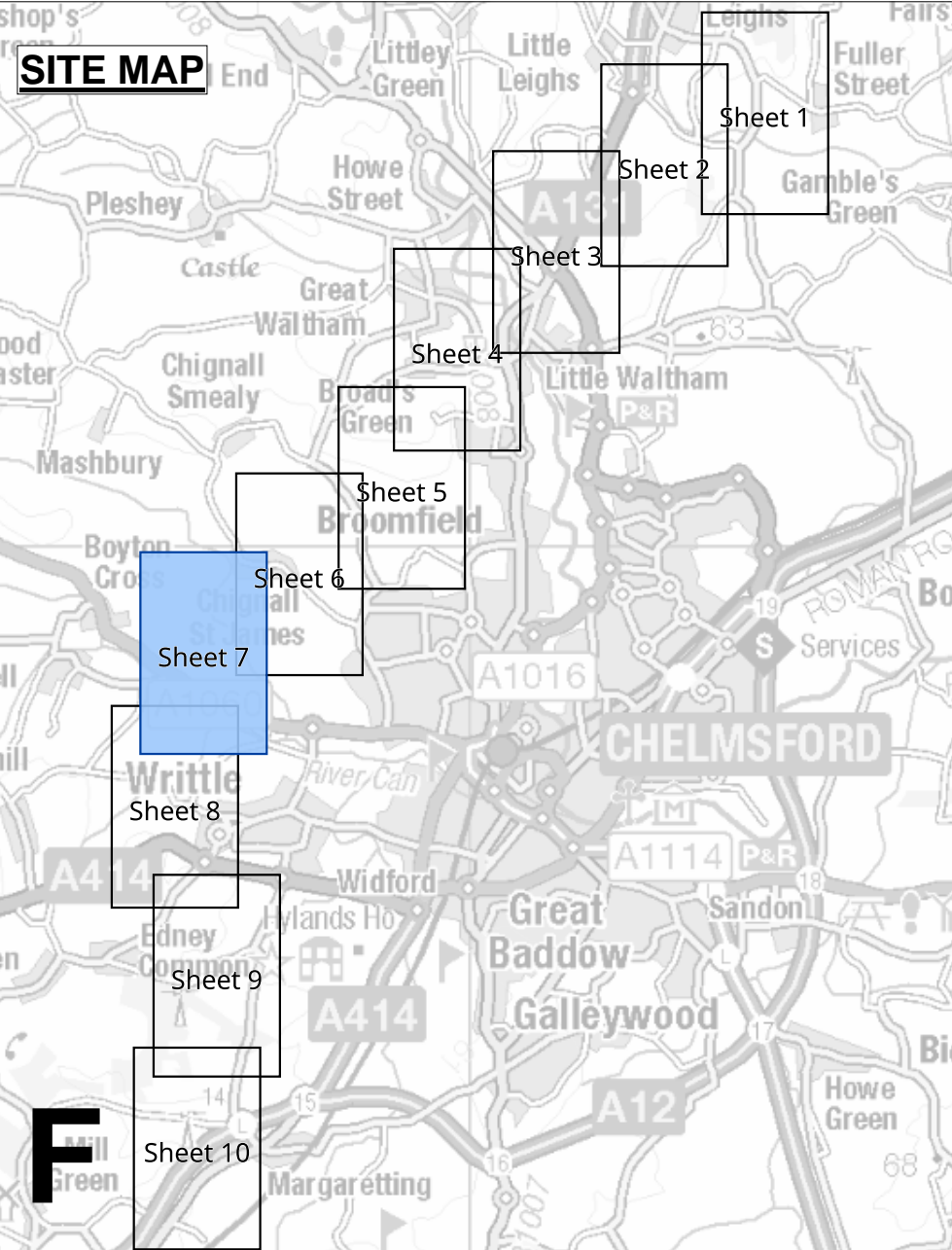
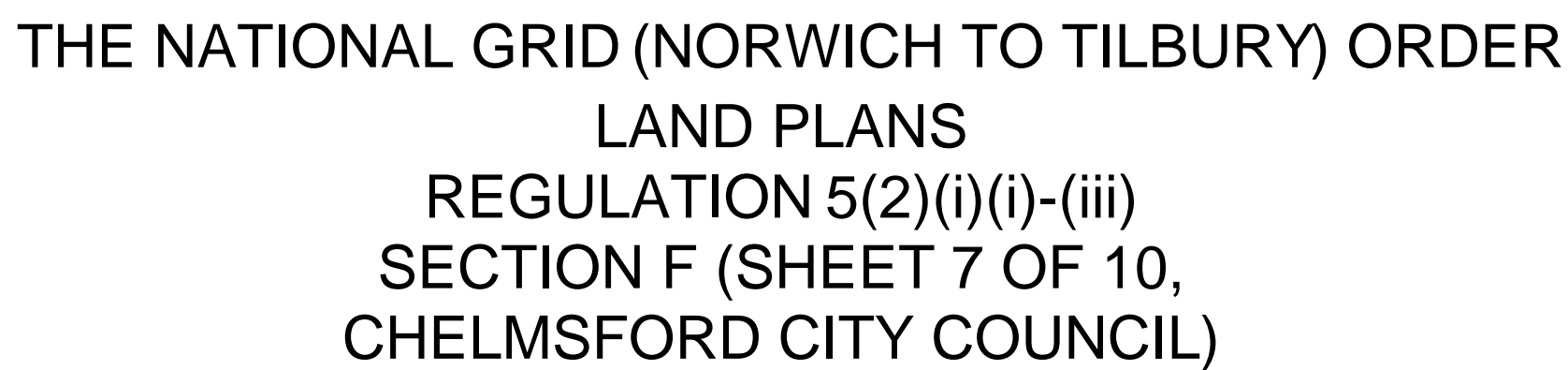

Legend

- Local authority boundary
- Section boundary & local authority boundary
- Section boundary
- Sheet index outlines
- Order Limits
- Class 1 - Compulsory acquisition of land
- Class 2 - Compulsory acquisition of rights - Overhead line
- Class 3 - Compulsory acquisition of rights - Underground cable system
- Class 4 - Compulsory acquisition of rights - Overhead line and underground cable system
- Class 5 - Compulsory acquisition of rights - Access
- Class 6 - Compulsory acquisition of rights - Drainage
- Class 7 - Temporary use
- Class 8 - Land not subject to powers of acquisition nor temporary use

Notes

1. For additional detail on the plan suites, please refer to the Guide to Plans (document reference 2.0), located in the Volume 2 of the DCO application.

2. This drawing is scaled at paper size A0, therefore any prints taken at smaller sizes will affect accuracy of the measurement units and should not be scaled against.

Coordinate System: British National Grid

Sheet X Centroid Coordinate : 586337

Sheet Y Centroid Coordinate : 208542

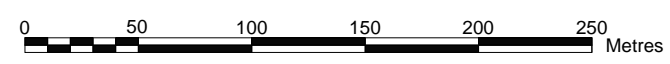

BACKGROUND MAPPING INFORMATION HAS BEEN REPRODUCED FROM THE ORDNANCE SURVEY BY PERMISSION OF ORDNANCE SURVEY OF THE CONTROLLER OF HIS MAJESTY'S STATIONERY OFFICE. © CROWN COPYRIGHT AND DATABASE RIGHTS(2025) LICENCE OS100024241 AND AC0000807948.

A	AUG-2025	For DCO submission	KRO	BBU	CLJ
---	----------	--------------------	-----	-----	-----

Issue	Date	Remarks	Drawn	Checked	Approved
Title:					

THE NATIONAL GRID
(NORWICH TO TILBURY) ORDER
LAND PLANS
REGULATION 5(2)(i)-(iii)
SECTION F (SHEET 7 OF 10
CHELMSFORD CITY COUNCIL)

nationalgrid

PINS Application Number

EN020027

National Grid Drawing Reference

AENC-TQST-LAN-DWG-0002

<u>Scale</u>	<u>Sheet Size</u>	<u>Sheet</u>	<u>Issue</u>
1:2500	A0	SHEET 7 of 10	A

THE NATIONAL GRID (NORWICH TO TILBURY) ORDER
LAND PLANS
REGULATION 5(2)(i)-(iii)
SECTION F (SHEET 8 OF 10,
CHELMSFORD CITY COUNCIL)

Application Document 2.2

SITE MAP

Legend

- Local authority boundary
- Section boundary & local authority boundary
- Section boundary
- Sheet index outlines
- Order Limits
- Class 1 - Compulsory acquisition of land
- Class 2 - Compulsory acquisition of rights - Overhead line
- Class 3 - Compulsory acquisition of rights - Underground cable system
- Class 4 - Compulsory acquisition of rights - Overhead line and underground cable system
- Class 5 - Compulsory acquisition of rights - Access
- Class 6 - Compulsory acquisition of rights - Drainage
- Class 7 - Temporary use
- Class 8 - Land not subject to powers of acquisition nor temporary use

Notes

- For additional detail on the plan suites, please refer to the Guide to Plans (document reference 2.0), located in the Volume 2 of the DCO application.
- This drawing is scaled at paper size A0, therefore any prints taken at smaller sizes will affect accuracy of the measurement units and should not be scaled against.

Coordinate System: British National Grid
Sheet X Centroid Coordinate : 565944 Sheet Y Centroid Coordinate : 206431

BACKGROUND MAPPING INFORMATION HAS BEEN REPRODUCED FROM THE ORDNANCE SURVEY BY PERMISSION OF ORDNANCE SURVEY OF THE CONTROLLER OF HIS MAJESTY'S STATIONERY OFFICE. © CROWN COPYRIGHT AND DATABASE RIGHTS(2025) LICENCE OS100024241 AND AC0000807946.

A AUG-2025 For DCO submission KRO AMI CLJ
Issue Date Remarks Drawn Checked Approved
Title:
THE NATIONAL GRID
(NORWICH TO TILBURY) ORDER
LAND PLANS
REGULATION 5(2)(i)-(iii)
SECTION F (SHEET 8 OF 10
CHELMSFORD CITY COUNCIL)

nationalgrid
PINS Application Number
EN020027
National Grid Drawing Reference
AENC-TQST-LAN-DWG-0002
Scale Sheet Size Sheet Issue
1:2500 A0 SHEET 8 of 10 A

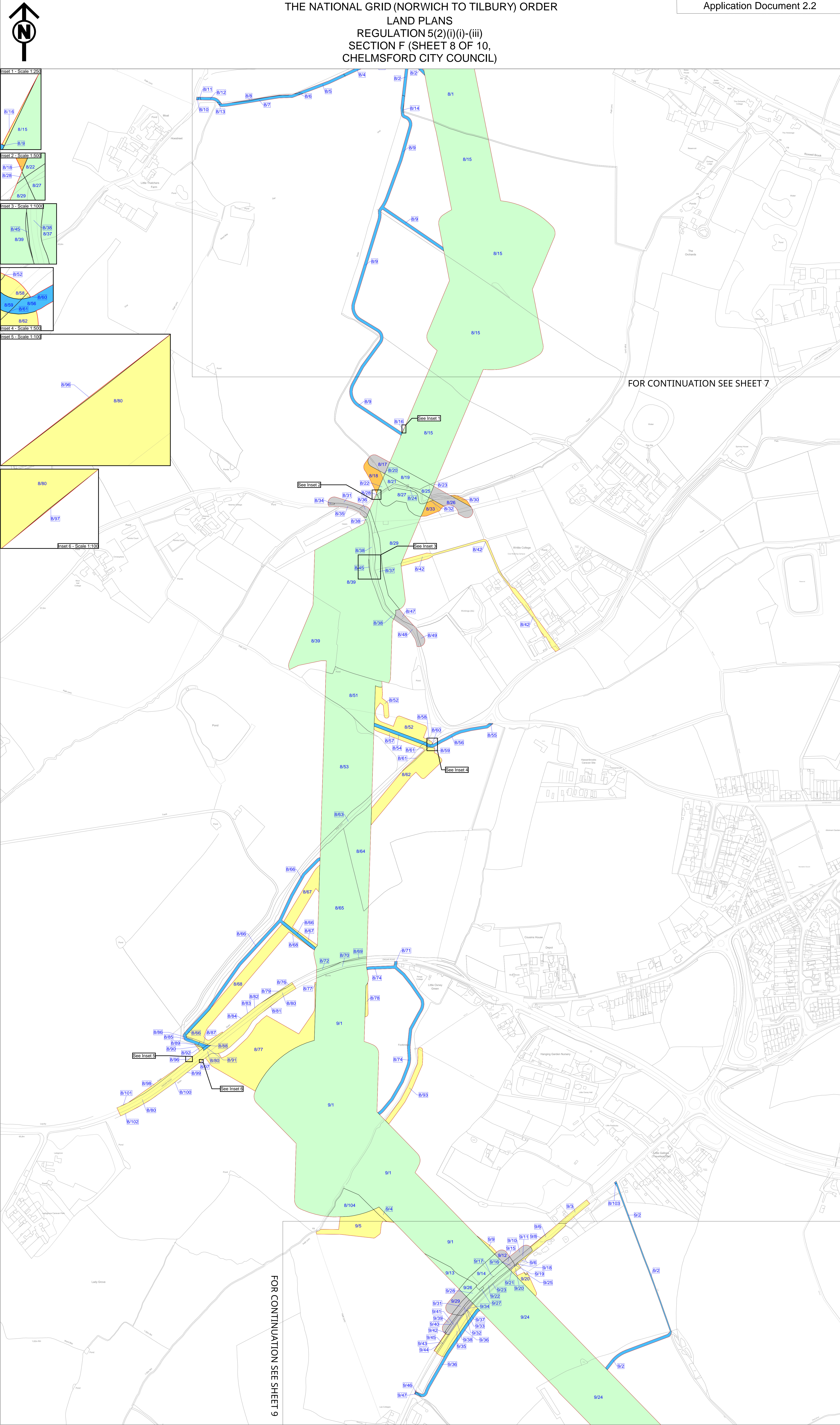

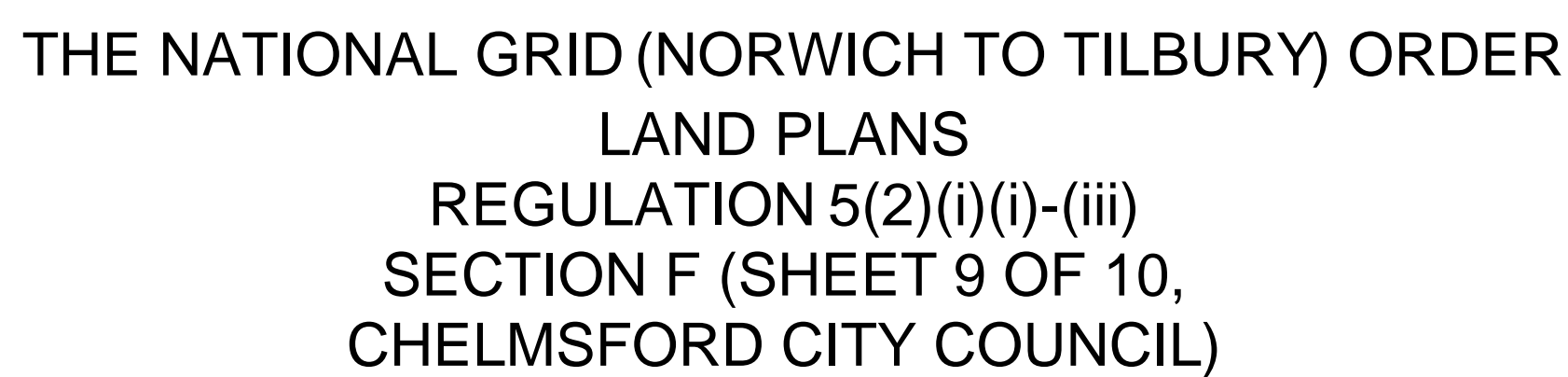

- ### Legend
- Local authority boundary
 - Section boundary & local authority boundary
 - Section boundary
 - Sheet index outlines
 - Order Limits
 - Class 1 - Compulsory acquisition of land
 - Class 2 - Compulsory acquisition of rights - Overhead line
 - Class 3 - Compulsory acquisition of rights - Underground cable system
 - Class 4 - Compulsory acquisition of rights - Overhead line and underground cable system
 - Class 5 - Compulsory acquisition of rights - Access
 - Class 6 - Compulsory acquisition of rights - Drainage
 - Class 7 - Temporary use
 - Class 8 - Land not subject to powers of acquisition nor temporary use

Notes

Notes

1. For additional detail on the plan suites, please refer to the Guide to Plans (document reference 2.0), located in the Volume 2 of the DCO application.

2. This drawing is scaled at paper size A0, therefore any prints taken at smaller sizes will affect accuracy of the measurement units and should not be scaled against.

Coordinate System: British National Grid
Sheet X Centroid Coordinate : 566519 Sheet Y Centroid Coordinate : 204110

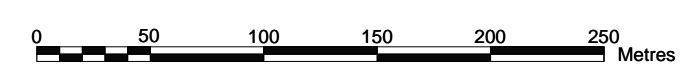

BACKGROUND MAPPING INFORMATION HAS BEEN REPRODUCED FROM THE ORDNANCE SURVEY BY PERMISSION OF ORDNANCE SURVEY OF THE CONTROLLER OF HIS MAJESTY'S STATIONERY OFFICE. © CROWN COPYRIGHT AND DATABASE RIGHTS(2025) LICENCE OS100024241 AND AC0000807948.

A	AUG-2025	For DCO submission	CBE	AMI	CLJ
Issue	Date	Remarks	Drawn	Checked	Approved

Title:

THE NATIONAL GRID
(NORWICH TO TILBURY) ORDER
LAND PLANS
REGULATION 5(2)(i)-(iii)
SECTION F (SHEET 9 OF 10
CHELMSFORD CITY COUNCIL)

nationalgrid

PINS Application Number

EN020027

National Grid Drawing Reference

AENC-TQST-LAN-DWG-0002

<u>Scale</u>	<u>Sheet Size</u>	<u>Sheet</u>	<u>Issue</u>
1:2500	A0	SHEET 9 of 10	A

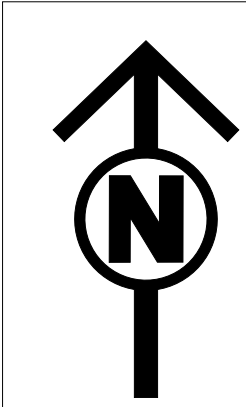

THE NATIONAL GRID (NORWICH TO TILBURY) ORDER
LAND PLANS
REGULATION 5(2)(i)-(iii)
SECTION F (SHEET 10 OF 10,
CHELMSFORD CITY COUNCIL AND BRENTWOOD BOROUGH COUNCIL)

Application Document 2.2

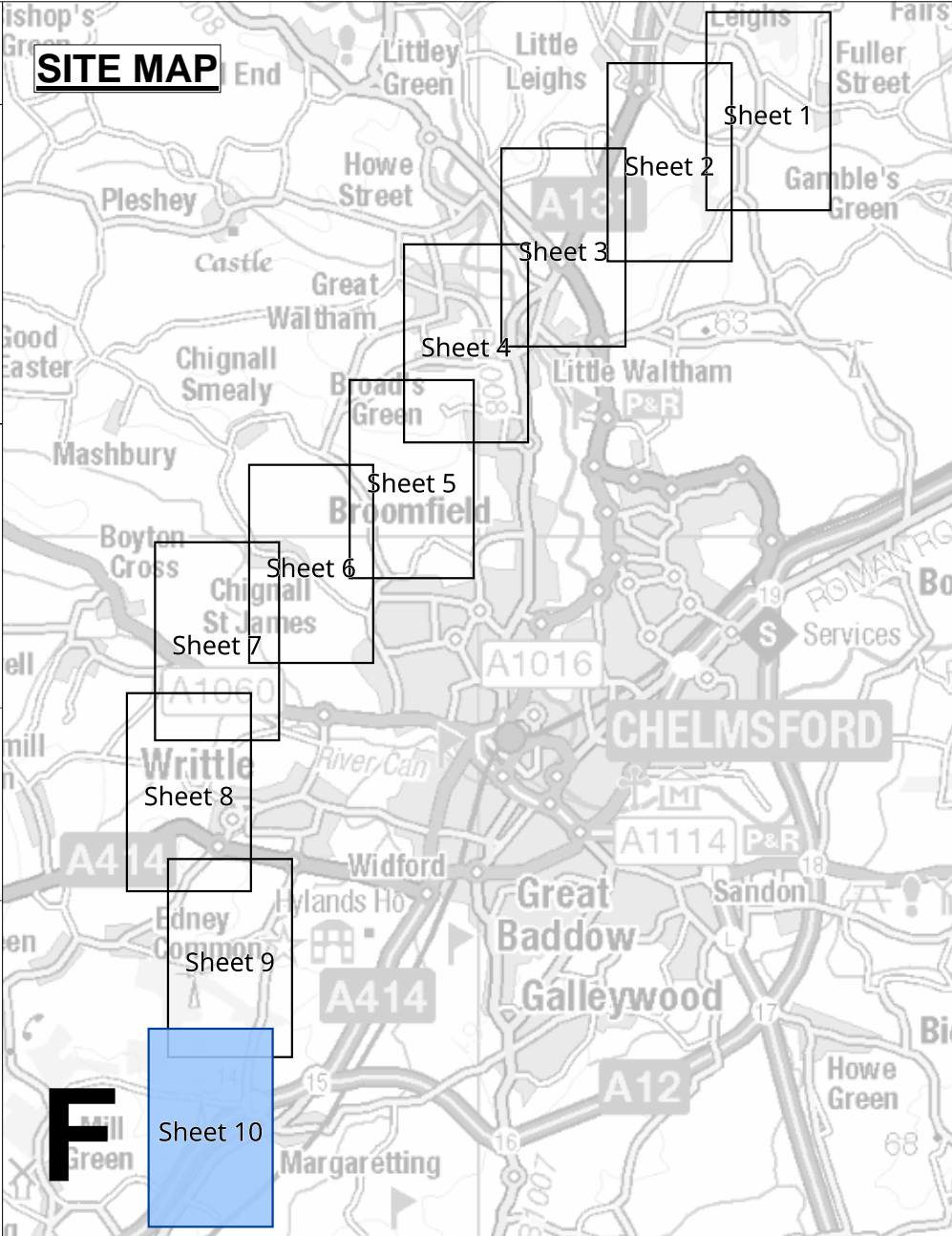
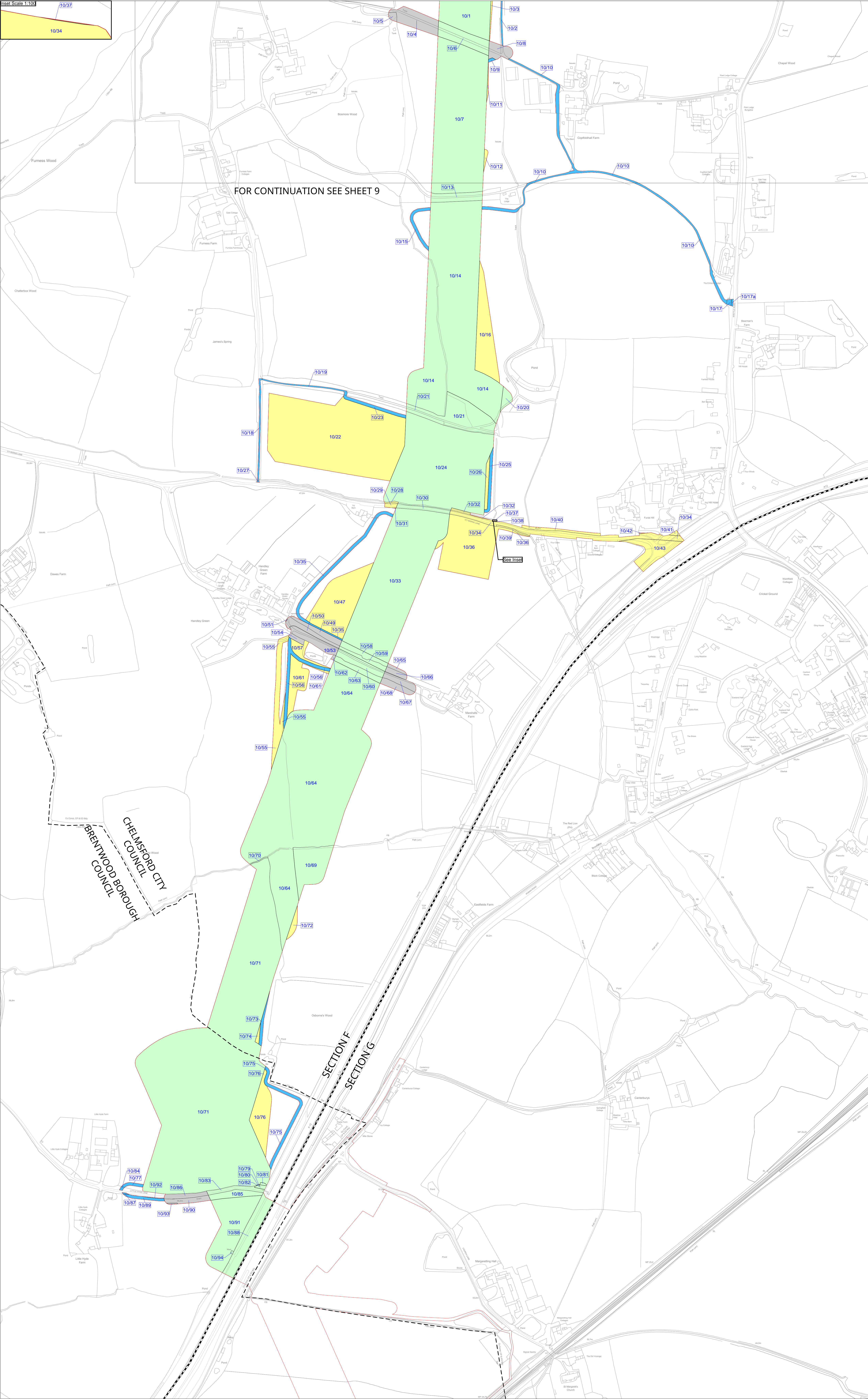
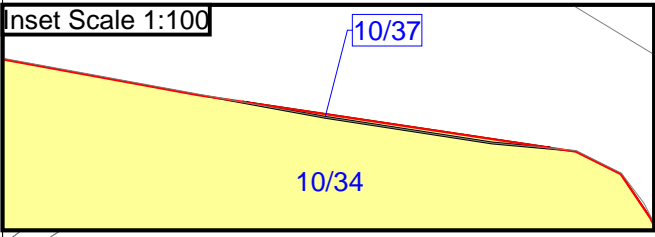

- Legend**
- Local authority boundary
 - Section boundary & local authority boundary
 - Section boundary
 - Sheet index outlines
 - Order Limits
 - Class 1 - Compulsory acquisition of land
 - Class 2 - Compulsory acquisition of rights - Overhead line
 - Class 3 - Compulsory acquisition of rights - Underground cable system
 - Class 4 - Compulsory acquisition of rights - Overhead line and underground cable system
 - Class 5 - Compulsory acquisition of rights - Access
 - Class 6 - Compulsory acquisition of rights - Drainage
 - Class 7 - Temporary use
 - Class 8 - Land not subject to powers of acquisition nor temporary use

Notes

1. For additional detail on the plan suites, please refer to the Guide to Plans (document reference 2.0), located in the Volume 2 of the DCO application.

2. This drawing is scaled at paper size A0, therefore any prints taken at smaller sizes will affect accuracy of the measurement units and should not be scaled against.

Coordinate System: British National Grid
Sheet X Centroid Coordinate : 566248 Sheet Y Centroid Coordinate : 201736

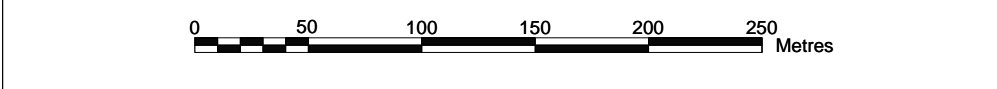

BACKGROUND MAPPING INFORMATION HAS BEEN REPRODUCED FROM THE ORDNANCE SURVEY BY PERMISSION OF ORDNANCE SURVEY OF THE CONTROLLER OF HIS MAJESTY'S STATIONERY OFFICE. © CROWN COPYRIGHT AND DATABASE RIGHTS(2025) LICENCE OS100024241 AND AC0000807946.

Issue	Date	Remarks	Drawn	Checked	Approved
A	AUG-2025	For DCO submission	CBE	KGA	CLJ

Title:

THE NATIONAL GRID
(NORWICH TO TILBURY) ORDER
LAND PLANS
REGULATION 5(2)(i)-(iii)
SECTION F (SHEET 10 OF 10
CHELMSFORD CITY COUNCIL AND
BRENTWOOD BOROUGH COUNCIL)

nationalgrid

PINS Application Number
EN020027

National Grid Drawing Reference
AENC-TOST-LAN-DWG-0002

Scale	Sheet Size	Sheet	Issue
1:2500	A0	SHEET 10 of 10	A